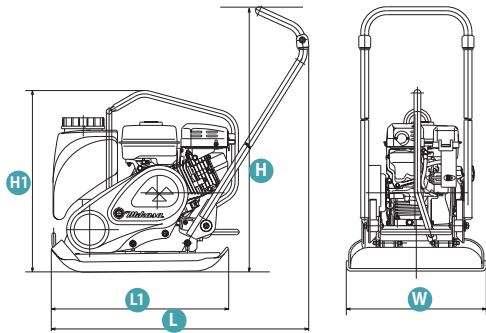

Plate Compactor

Heavy Duty line



MVC-F60 VAS
(80kg)



Standard line

MVC-40
(50kg)



MVC-50
(59kg)



MVC-F60
(65kg)



model	HAV (Hand Arm Vibration) (M/sec ²)
MVC-F60H VAS	3.3
MVC-F80H VAS	3.5
MVC-T90H VAS	2.1
MVC-T100D VAS	2.3

Remarks:

HAV is measured in comply with EU Directive 2002/44/EC. The value is shown as 3 axis min. vibration level. Test course is in comply with EN500-4.

Test course: Crushed gravel

+ Option

Water Tank

9: For MVC-40/50



11: For MVC-F60/F70/e60

13: For MVC-F80/T90/T100



Rubber Mat

(Reversible Design) for T90/T100



MVC Specifications

model	weight (kg)	dimensions (mm)	plate size (mm)	vibrating frequency Hz (V.P.M.)	centrifugal force(max) kN (kgf)	max.traveling speed (m/min)	max.limited gradeability (%)	power source kW (PS)
MVC-F60H VAS	80	H : 995 H1: 580 L : 915	W: 350 L1: 570	93 (5,600)	10.1 (1,030)	25	35	Honda GX120 gasoline max. output 2.4 (3.3)
MVC-F80H VAS	92		W: 450 L1: 570		13.7 (1,400)			
MVC-T90H VAS	108	H : 950 H1: 560 L : 1,050	W: 500 L1: 525	100 (6,000)	15.0 (1,530)			Honda GX160 gasoline max. output 3.6 (4.9)

MVC-F80 VAS (92kg)



MVC-T90 VAS (108kg)



MVC-F80 (78kg)



MVC-T90 (91kg)

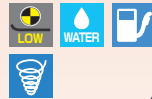

MVC-T100D (103kg)



Increased Weight (kg)

model	Water Tank	Cart	Folding Handle	VAS Handle
MVC-40H	+6	nil	standard	nil
MVC-40HR	+6	nil	standard	nil
MVC-50H	+6	nil	+1	nil
MVC-e60	+8	+2	nil	standard
MVC-F60H	+8	+2	nil	+5
MVC-F70H	+8	+2	nil	nil
MVC-F80H	+9	+2	nil	+3
MVC-T90H	+10	+4	nil	+3
MVC-T100D	+10	+4	nil	+3

*The weight of tank is 50% of water.
ex.) MVC-F60H with Tank & Cart & VAS = increased "15kg"

MVC Specifications

model	weight (kg)	dimensions (mm)	plate size (mm)	vibrating frequency Hz (V.P.M.)	centrifugal force (max) kN (kgf)	max.traveling speed (m/min)	max.limited gradeability (%)	power source kW (PS)
MVC-40H	50	H : 920 H1: 610 L : 910	W: 295 L1: 420	103 (6,200)	7.2 (730)	25	35	Honda GX100 gasoline max. output 2.1 (2.9)
MVC-40HR	51	H : 920 H1: 620 L : 910	W: 295 L1: 420	103 (6,200)	7.2 (730)			Honda GXR120 gasoline max. output 2.3 (3.1)
MVC-50H	59	H : 920 H1: 545 L : 915	W: 345 L1: 460	97 (5,800)	9.8 (1,000)			Honda GX120 gasoline max. output 2.4 (3.3)
MVC-F60H	65	H : 865 H1: 580 L : 925	W: 350 L1: 510	93 (5,600)	10.1 (1,030)			Honda GX160 gasoline max. output 3.6 (4.9)
MVC-F70H	73		W: 420 L1: 510		12.0 (1,220)			
MVC-F80H	78		W: 450 L1: 570		13.7 (1,400)			
MVC-T90H	91	H : 825 H1: 560 L : 1,100	W: 500 L1: 525	100 (6,000)	15.0 (1,530)			Yanmar L48N diesel max. output 3.5 (4.7)
MVC-T100D	103	H : 825 H1: 650 L : 1,100						

power unit series emits no exhaust gas and does not pollute the air

Plate Compactor

Power Unit Series



- Rugged double compaction baseplate design



- Start and stop can be done with the push of a switch.

- 11L Water tank as standard.

NEW MVC-e60 VAS (88kg)



- VAS Handle to reduce hand-arm vibration.



- Full-coverage belt cover

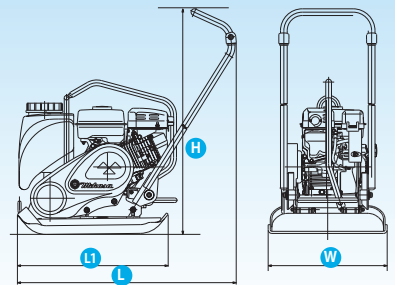

model	weight (kg)	dimensions (mm)	plate size (mm)	vibrating frequency Hz (v.p.m)	centrifugal force(max) kN(kgf)	max.traveling speed(m/min)	max.limited gradeability (%)	power source kW (PS)
MVC-e60 VAS	* 88	H : 995 L : 915	W : 350 L1 : 570	93(5,600)	10.1 (1,030)	25	35(20)	Honda DC power unit GXE2.0 1.6(2.2)

* incl. power unit battery.

Reversible Compactor

Power Unit Series



- Start and stop can be done with the push of a switch.

NEW MVH-eR60 (81kg)



- Smooth forward/reverse operation by hand pump with built-in accumulator

- Guard frame for both dustproofing and ease of maintenance



- Height-adjustable handle (3 levels)

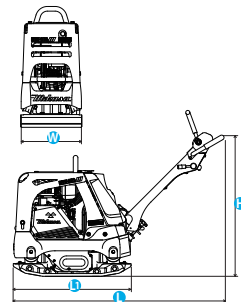

model	weight (kg)	dimensions (mm)	plate size (mm)	vibration frequency Hz (v.p.m)	centrifugal force (kgf)	max.traveling speed	power source kW (PS)
MVH-eR60	* 81	H : 915 L : 920	W : 350 L1 : 480	108 (6,500)	12 (1,225)	24	Honda DC power unit GXE2.0 1.6(2.2)

* incl. power unit battery.